

THE POSITION OF POLE LINES, CONDUITS, WATERMAIN, SEWERS & OTHER OVERGROUND & UNDERGROUND UTILITIES & STRUCTURES IS NOT NECESSARILY SHOWN ON THE CONTRACT DRAWING, & WHERE SHOWN, THE ACCURACY OF SUCH UTILITIES & STRUCTURES IS NOT GUARANTEED. BEFORE STARTING WORK, THE CONTRACTOR SHALL INFORM HIMSELF OF THE EXACT LOCATION OF ALL UTILITIES & STRUCTURES, & SHALL ASSUME ALL LIABILITY FOR DAMAGE TO THEM

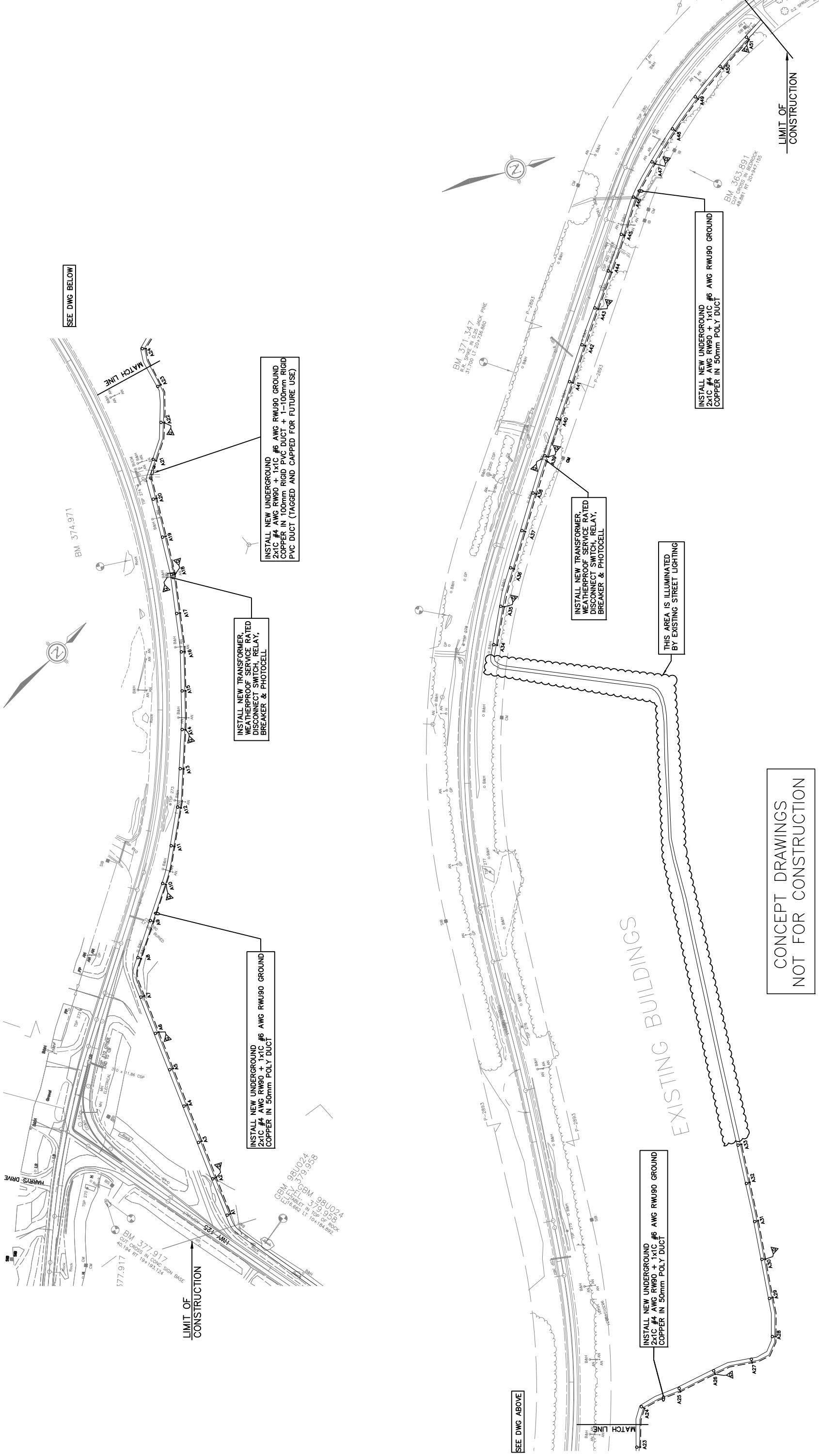

<p>Legend</p> <ul style="list-style-type: none"> --- UNDERGROUND TRAIL LIGHTING WIRING ☐ POLE MOUNTED TRANSFORMER ○ LED TRAIL LIGHTING ON 4.27m (14') POLE △ 19x3000 COPPER CLAD GROUND ROD, #6AWG COPPER GROUND CONDUCTOR, INSTALLED WHERE INDICATED ==== RIGID PVC DUCT FOR ROAD CROSSING, NUMBER OF 100mm DUCTS AS INDICATED 		<p>Approved</p>	
<p>NO. REVISION</p>		<p>DATE INITIAL</p>	
<p>A ISSUED FOR PRELIMINARY DESIGN REPORT</p>		<p>NOV/15 KBH/RD</p>	
<p>PRELIMINARY</p>		<p>ELECTRICAL TRAIL LIGHTING LAYOUT</p>	
<p>MUNICIPALITY OF RED LAKE</p>		<p>TRAIL LIGHTING</p>	
<p>RED LAKE TO BALMERTOWN</p>		<p>RED LAKE TO BALMERTOWN</p>	

Scale: 0 15m 30m

Drawn By: KBH Date: OCT 2015

Ckd. By: KB/RD

Dwg. No. A1-353111-E1 (Rev. A)

THE POSITION OF POLE LINES, CONDUITS, WATERMAIN, SEWERS & OTHER OVERGROUND & UNDERGROUND UTILITIES & STRUCTURES IS NOT NECESSARILY SHOWN ON THE CONTRACT DRAWING, & WHERE SHOWN, THE ACCURACY OF SUCH UTILITIES & STRUCTURES IS NOT GUARANTEED. BEFORE STARTING WORK, THE CONTRACTOR SHALL INFORM HIMSELF OF THE EXACT LOCATION OF ALL UTILITIES & STRUCTURES, & SHALL ASSUME ALL LIABILITY FOR DAMAGE TO THEM

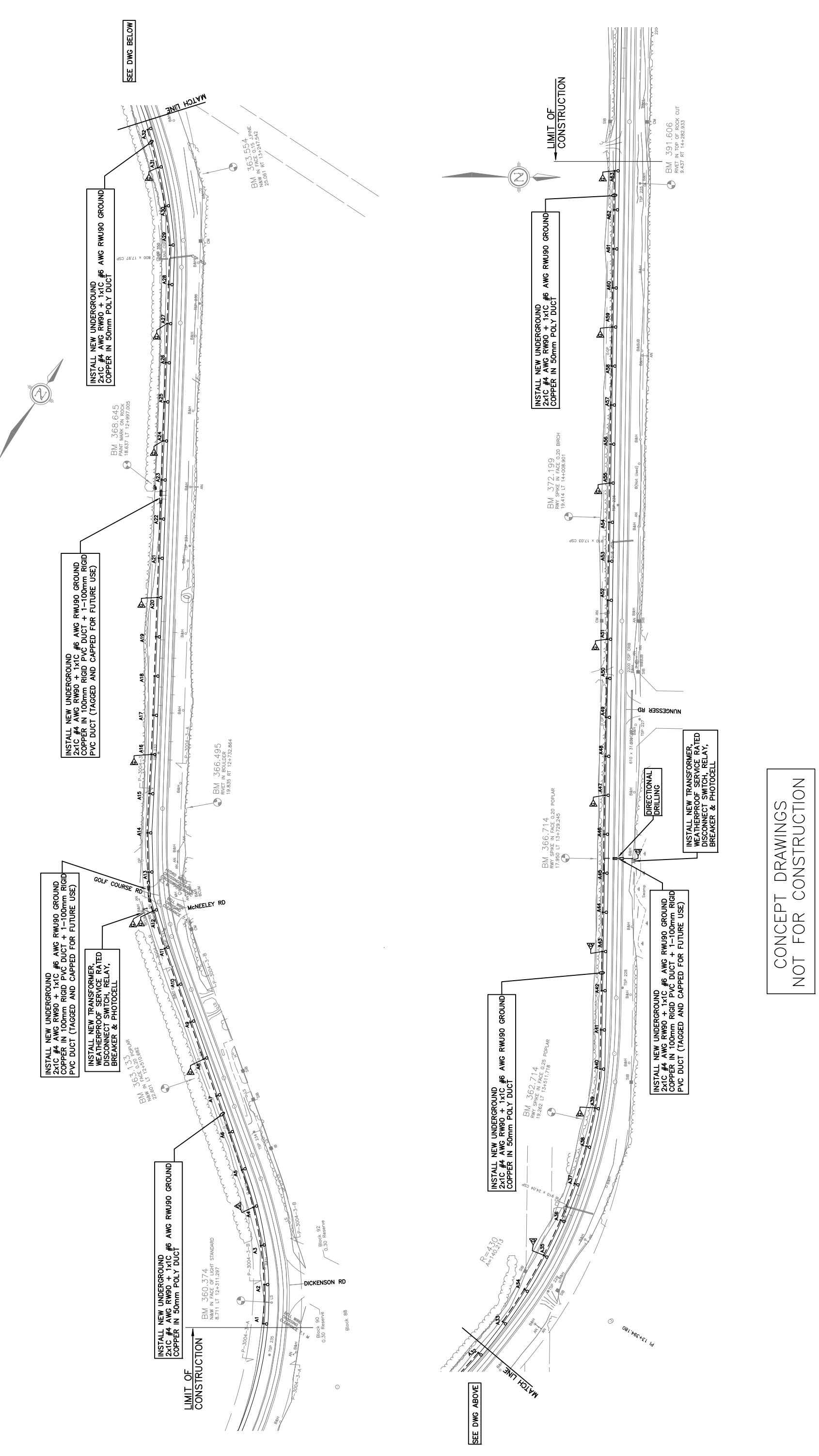

Hatch Mott MacDonald

Drawn By KBH
Ckd. By KB/RD
Scale 0 15m 30m

Date OCT 2015
Dwg. No. A1-353111-E2
Rev. A

MUNICIPALITY OF RED LAKE

TRAIL LIGHTING

ELECTRICAL TRAILS LIGHTING LAYOUT

BALMERTOWN TO COCHENOUR

No.	Revision	Date	Initial
A	ISSUED FOR PRELIMINARY DESIGN REPORT	NOV/15	KBH/RD

Approved

PRELIMINARY

CONCEPT DRAWINGS
NOT FOR CONSTRUCTION

Legend

- UNDERGROUND TRAIL LIGHTING WIRING
- POLE MOUNTED TRANSFORMER
- LED TRAIL LIGHTING ON 4.27m (14') POLE
- △ 19x3000 COPPER CLAD GROUND ROD, #6AWG COPPER GROUND CONDUCTOR, INSTALLED WHERE INDICATED
- ==== RIGID PVC DUCT FOR ROAD CROSSING, NUMBER OF 100mm DUCTS AS INDICATED